

FLAT D5 | 3 B 2T

Available in Tower E

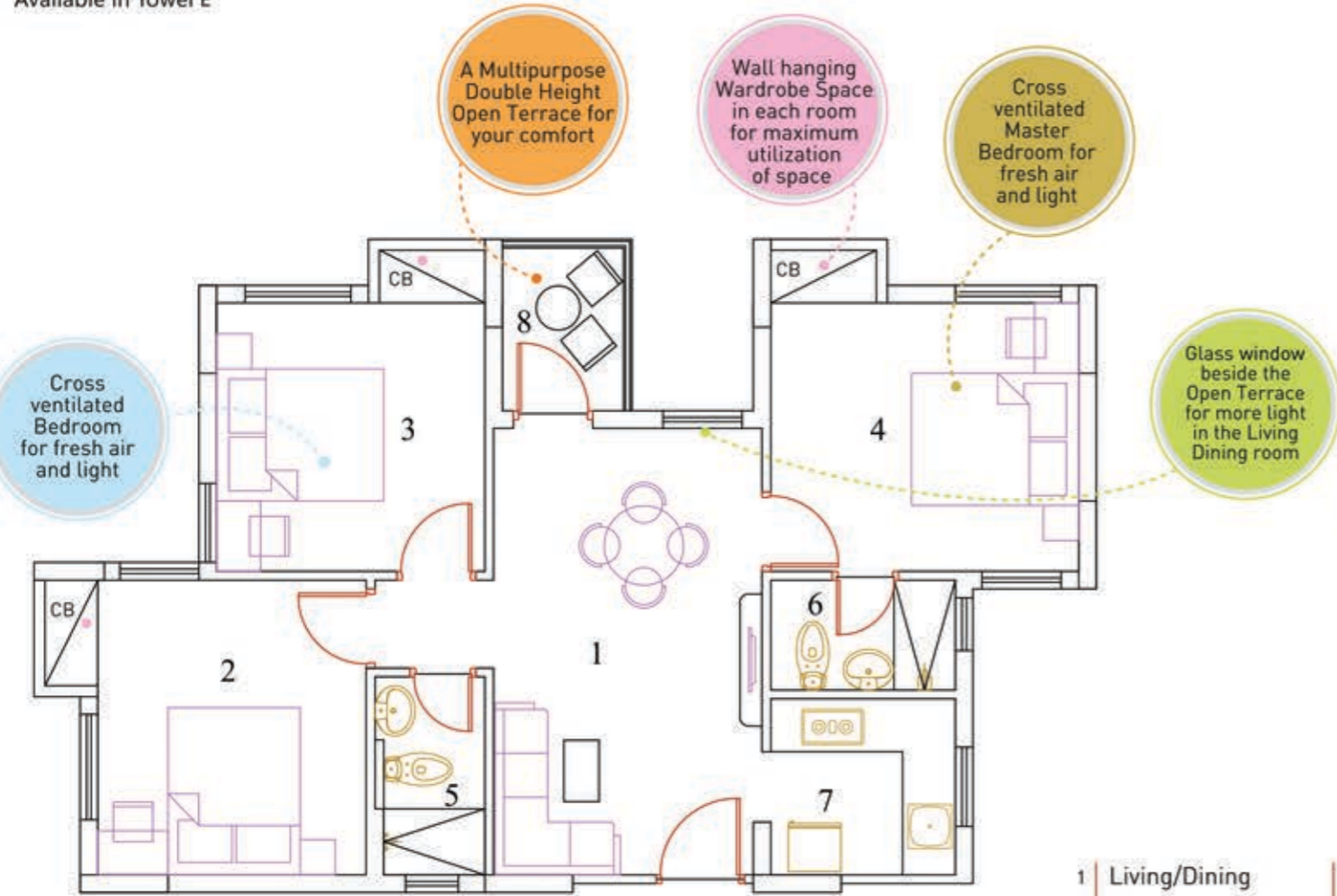

Carpet area 656 sq.ft

Carpet area + Balcony 686 sq.ft

Built up area 766 sq.ft

Standard built up area 1065 sq.ft

1	Living/Dining	16'-8"X10'-0"
2	Bed room	12'-0"X11'-0" (10'-0" X 11'-0"without CB)
3	Bed room	12'-0"X10'-0" (10'-0" X 10'-0"without CB)
4	Bed room	12'-0"X11'-6" (10'-0" X 11'-6"without CB)
5	Toilet	7'-5"X4'-1"
6	Toilet	6'-11"X4'-1"
7	Kitchen	6'-11" X 6'-7"
8	Open terrace	6'-5"X4'-10"